

Water Storage Tanks Price List

February 2016







Price List W/WW- 020116
Supersedes Price List WWW-020115

February 1, 2016
(February 1, 2015)

making a **lasting** difference[®]

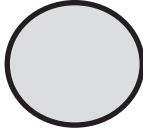
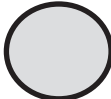
www.xerxes.com

Single-Wall and Double-Wall Tanks



Tank Diameter	Nominal Gallons	Single-Wall Base Tank ¹	Double-Wall Base Tank ²	NSF Adder ³	Equipped for Onsite Pressure Test ⁴	
 12 Foot ⁵	50,000	\$174,690	\$326,671	\$12,788	\$2,721	
	48,000	162,037	302,548	11,616	2,645	
	45,000	143,171	266,364	11,275	2,559	
	40,000	108,673	206,476	9,762	2,559	
	35,000	101,512	192,860	9,120	2,423	
	30,000	97,950	177,073	8,353	2,312	
	25,000	67,385	133,353	7,015	2,096	
	20,000	43,924	114,462	5,860	1,997	
 10 Foot	40,000	87,658	166,572	13,629	\$2,292	
	35,000	73,223	139,461	11,668	2,223	
	30,000	60,523	116,639	9,965	2,152	
	25,000	49,936	97,119	8,114	2,152	
	22,000	42,377	85,465	6,565	2,006	
	20,000	33,419	70,790	5,008	1,936	
	15,000	25,971	57,357	4,085	1,861	
	14,000	24,769	55,589	3,927	1,806	
	13,000	23,565	53,123	3,773	1,750	
	12,000	22,364	50,776	3,633	1,698	
	11,000	20,877	49,137	3,472	1,648	
	10,000	19,382	47,497	3,299	1,591	
	 8 Foot	15,000	27,452	60,764	6,253	1,861
		14,000	24,409	56,886	6,017	1,806
13,000		21,378	53,429	5,746	1,750	
12,000		18,340	43,153	4,574	1,698	
11,000		17,274	38,839	4,306	1,648	
10,000		16,207	34,571	4,062	1,591	
9,000		15,170	32,400	3,792	1,540	
8,000		14,124	29,832	3,557	1,498	
7,000		12,964	28,524	3,283	1,457	
6,000		11,801	26,797	3,011	1,413	
5,000		10,375	23,690	2,769	1,368	
4,000		9,071	20,586	2,531	1,328	
3,000		7,881	N/A	2,285	1,243	
 6 Foot		8,000	16,001	34,696	3,715	1,750
	6,000	13,117	29,866	3,117	1,413	
	5,000	11,675	27,451	2,822	1,389	
	4,000	10,503	24,009	2,555	1,328	
	3,000	9,024	20,293	2,169	1,243	
	2,000	7,581	N/A	1,996	1,144	
	1,500	6,271	N/A	1,802	1,043	
	1,500	7,214	16,415	1,829	1,043	
 4 Foot	1,000	5,216	12,454	1,229	762	
	600	4,040	9,116	1,085	762	

Notes:

1. Base tank prices do not include any access openings or other accessories. Prices do include standard lifting lug(s).
2. Base tank prices only include a lift lug(s), and an interstitial monitor access fitting. Base prices DO NOT include any fittings, manways or other accessories.
3. All NSF tanks must have a manway.
4. Optional price adder for tank accessories that allow for onsite pressure-testing. This onsite pressure testing option is not available with the use of certain accessories.
- 5 Available from Anaheim, CA, or Hagerstown, MD, only.

Tank Anchoring

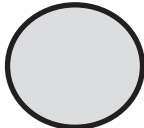
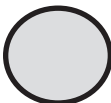
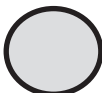
Prices shown reflect per tank pricing, based on quantities required for each anchoring component.

Tank Diameter	Nominal Gallons	No. and Size of Deadmen	Standard Hold- Down Straps	MOH Hold-Down Straps	Deadmen	Turnbuckles
 12 Foot	50,000	6 - 22'	\$8,672 (18)	\$30,264	see note 2 below	\$11,193
	48,000	6 - 22'	8,672 (18)	30,264	see note 2 below	11,193
	45,000	4 - 22" & 2 - 18'	7,709 (16)	26,901	see note 2 below	9,949
	40,000	6 - 18'	5,782 (12)	20,176	see note 2 below	7,462
	35,000	2 - 22' & 4 - 14'	5,782 (12)	20,176	see note 2 below	7,462
	30,000	4 - 22'	4,818 (10)	16,813	see note 2 below	6,218
	25,000	4 - 18'	3,854 (8)	13,451	see note 2 below	4,974
	20,000	4 - 14'	2,891 (6)	10,088	see note 2 below	3,731
 10 Foot	40,000	8 - 18'	4,939 (14)	\$22,736	\$14,068	\$8,705
	35,000	2-18' & 4-22'	4,234 (12)	19,488	11,093	7,462
	30,000	6 - 18'	3,528 (10)	16,240	10,551	6,218
	25,000	4-14' & 2-18'	2,822 (8)	12,992	9,872	4,974
	22,000	4 - 22'	2,822 (8)	12,992	7,576	4,974
	20,000	4 - 18'	2,117 (6)	9,744	7,034	3,731
	15,000	4 - 14'	1,411 (4)	6,496	6,355	2,487
	14,000	4 - 14'	1,411 (4)	6,496	6,355	2,487
	13,000	4 - 14'	1,411 (4)	6,496	6,355	2,487
	12,000	2 - 22'	1,411 (4)	6,496	3,788	2,487
	11,000	2 - 22'	1,411 (4)	6,496	3,788	2,487
	10,000	2 - 22'	1,411 (4)	6,496	3,788	2,487
 8 Foot	15,000	6 - 16'	1,905 (6)	9,479	7,349	3,109
	14,000	4-16' & 2-12'	1,905 (6)	9,479	6,928	3,109
	13,000	2-16' & 4-12'	1,905 (6)	9,479	6,507	3,109
	12,000	4 - 18'	1,270 (4)	6,320	5,389	2,073
	11,000	2-18' & 2-16'	1,270 (4)	6,320	5,144	2,073
	10,000	4 - 16'	1,270 (4)	6,320	4,900	2,073
	9,000	2-16' & 2-12'	1,270 (4)	6,320	4,478	2,073
	8,000	4 - 12'	1,270 (4)	6,320	4,057	2,073
	7,000	4 - 12'	1,270 (4)	6,320	4,057	2,073
	6,000	2 - 18'	635 (2)	3,160	2,695	1,036
	5,000	2 - 16'	635 (2)	3,160	2,450	1,036
	4,000	2 - 12'	635 (2)	3,160	2,029	1,036
	3,000	2 - 12'	635 (2)	3,160	2,029	1,036
	 6 Foot	8,000	4 - 12' & 2 - 16'	1,700 (6)	9,340	6,507
6,000		4 - 16'	1,133 (4)	6,227	4,900	1,596
5,000		4 - 12'	1,133 (4)	6,227	4,057	1,596
4,000		2 - 18'	567 (2)	3,113	2,695	798
3,000		2 - 16'	567 (2)	3,113	2,450	798
2,000		2 - 12'	567 (2)	3,113	2,029	798
1,500		2 - 12'	567 (2)	3,113	2,029	798
 4 Foot	1,500	2 - 16'	540 (2)	N/A	2,450	798
	1,000	2 - 12'	540 (2)	N/A	2,029	798
	600	2 - 12'	540 (2)	N/A	2,029	798

Notes:

1. In most cases deadmen are shipped with the tank at no additional freight expense. Exceptions may apply for some 10' tanks. Deadmen that are shipped without tanks will require additional freight.
2. For 12' Deadmen pricing, please contact your local Xerxes sales representative.

Tank Accessories

Inlet/Outlet Straight Pipe, PVC or FRP¹

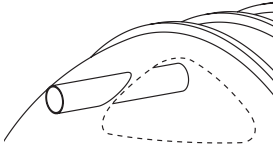

Inlet/Outlet Straight Pipe	PVC	FRP
2" I.D. Pipe	\$ 535	\$ 696
3" I.D. Pipe	592	761
4" I.D. Pipe	608	792
6" I.D. Pipe	742	968
8" I.D. Pipe	868	1,121
10" I.D. Pipe	1,198	1,680
12" I.D. Pipe	1,496	2,050

Inlet/Outlet Sanitary Tee, PVC³

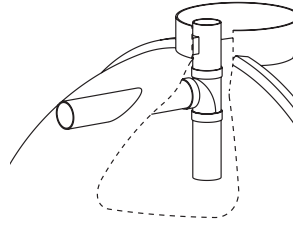

Inlet/Outlet Sanitary Tee	Unit Price
2" I.D. Pipe	\$ 873
3" I.D. Pipe	979
4" I.D. Pipe	1,074
6" I.D. Pipe	1,538
8" I.D. Pipe	1,868
10" I.D. Pipe	2,205
12" I.D. Pipe	2,538

Access Openings^{2,3}

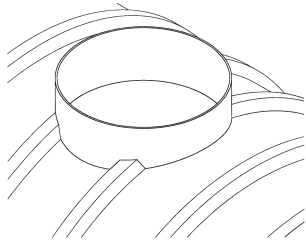

Access Openings	Unit Price
24" Nominal Diameter	\$1,548
30" Nominal Diameter	1,784
36" Nominal Diameter	2,422
48" Nominal Diameter	4,127

PVC Smoothing Inlet Tee

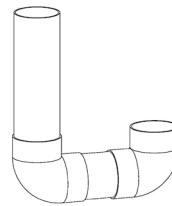

Size	Includes PVC Inlet Tee	Includes PVC Vertical Inlet
2" I.D. Pipe	\$1,331	\$ 962
3" I.D. Pipe	1,662	1,275
4" I.D. Pipe	1,955	1,489
6" I.D. Pipe	2,979	2,182
8" I.D. Pipe	4,182	3,182
10" I.D. Pipe	7,844	6,837
12" I.D. Pipe	9,789	8,748

Access Openings with Internal Flange^{2,3}

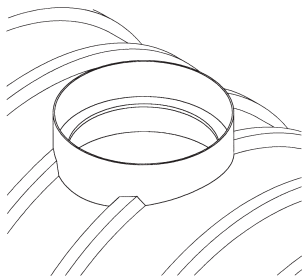

Access Openings with Internal Flange	Unit Price
24" Nominal Diameter	\$1,778
30" Nominal Diameter	2,093

Manways

Manways are flanged with a blank (no fittings) steel cover, gasket and bolting hardware.

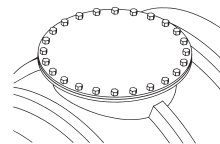

Manways	Unit Price
22" I.D.	\$2,469
30" I.D.	4,847
36" I.D.	9,124

Manway Cover NPT Fittings

NPT fittings in steel manway covers only.

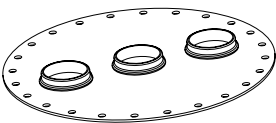

Size	Half-Coupling	Full-Coupling
2"	\$310	\$ 433
4"	320	448
6"	593	768
8"	1,073	1,419

Manway Accessories

Size	Steel Manway Cover	Set of Bolts, Nuts, Washers, Gasket	Gasket Only	Stainless-Steel (#304) Manway Hardware (Bolts, Nuts, Washers)
22" I.D.	\$425	\$227	\$178	\$684
30" I.D.	941	326	247	843
36" I.D.	1,173	551	348	1,051

Notes:

- FRP must be used for all potable water applications and all other applications where pipe penetrates below tank centerline.
- Multiple access openings on a tank must maintain one rib space between them.
- 30" dia. (or larger) access opening required for 6" dia. or larger tee.

Tank Accessories

Fiberglass Manway Extensions

Includes gasket and hardware. Minimum height of 2 feet.

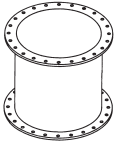

Manway Extensions	2'	3'	4'	5'	6'
22" I.D.	\$1,554	\$1,955	\$2,358	\$2,760	\$3,161
30" I.D.	4,059	5,511	6,524	7,757	8,992
36" I.D.	6,345	8,243	10,141	12,040	13,938

PVC and FRP Access Risers and FRP Lid Kits

Kits include a gasketed FRP lid with self-tapping screws or bolts. PVC risers include adhesive. FRP risers include FRP bonding kits.

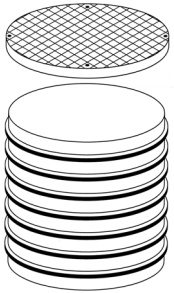

PVC Risers	2'	3'	4'	5'	6'
24" I.D.	\$ 744	\$ 919	\$ 1,095	\$1,270	\$ 1,447
30" I.D.	969	1,180	1,389	1,601	1,808

FRP Risers	2'	3'	4'	5'	6'
24" I.D.	\$1,237	\$1,394	\$1,568	\$1,726	\$1,894
30" I.D.	1,926	2,228	2,427	2,668	2,924
36" I.D.	2,101	2,490	2,830	3,195	3,560
48" I.D.	4,818	5,274	5,665	6,186	6,706

Full Bottom Drain Reinforcement

Nozzle price adder for full-bottom drain \$449



FRP Extensions with Hinged & Lockable Lids For use with manways.

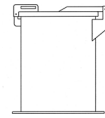

	3'	4'	5'	6'
22" I.D.	\$3,644	\$3,860	\$4,074	\$4,287
30" I.D.	4,397	4,637	4,872	5,112

FRP Extensions with Hinged & Lockable Lids For use with access openings.

Adhesive/bonding materials not included.

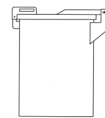

	3'	4'	5'	6'
24" I.D.	\$2,751	\$2,936	\$3,117	\$3,304
30" I.D.	3,042	3,298	3,552	3,813

FRP Bonding Kits

Fiberglass materials and miscellaneous items necessary to complete one FRP riser bond. One kit necessary for each circumferential bond.

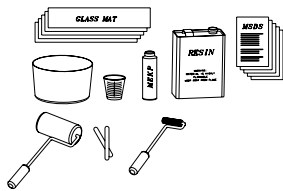

	Price
One FRP kit	\$359

Tank Mounted NPT and Flanged Fittings

Half-Couplings or Full-Couplings

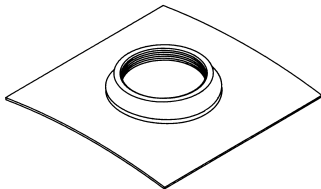

Size	Half-Coupling	Full-Coupling
2"	\$289	\$380
4"	331	420
6"	478	582

Duplex Half-Couplings

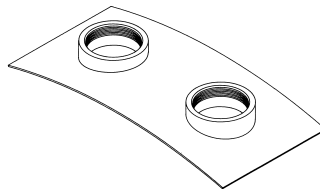

Size	Unit Price
2"	\$469
4"	669
6"	792

FRP Flanged Fitting

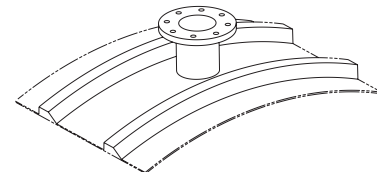

Size	Flanged Fitting	Dual Flanged Fitting
2"	\$1,413	\$2,692
3"	1,602	3,052
4"	1,782	3,394
6"	2,105	4,008
8"	3,016	5,744
10"	3,534	N/A
12"	4,035	N/A
14"	4,421	N/A
16"	4,854	N/A

Containment Sumps and Collars

Xerxes single-wall containment sumps are designed for use with Xerxes containment collars. Field assembly of single-wall sumps to collars is accomplished by the use of Xerxes supplied adhesive or the optional FRP bonding kits found on page 4.

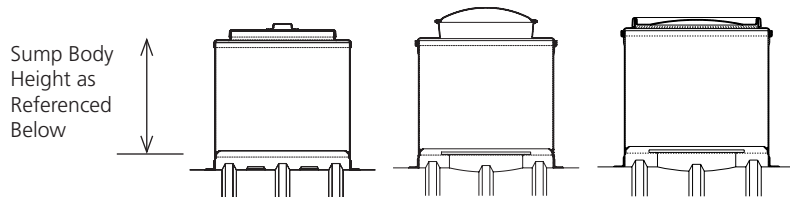

Single and Double-Wall Containment Collars

Factory-installed containment collars can be ordered to surround fittings or a manway. Strap locations may be affected.

Sump Body Height	32" Friction-Fit Cover*	30" Watertight Cover	36" Watertight Cover
36"	\$1,594	\$3,642	\$4,453
42"	1,741	3,768	4,581
48"	1,888	3,888	4,702
54"	2,032	4,016	4,826
60"	2,183	4,165	4,975
66"	2,336	4,316	5,127
72"	2,480	4,466	5,278
36"	2,285	4,854	\$5,664
42"	2,404	4,973	5,785
48"	2,543	5,127	5,940
54"	2,693	5,249	6,060
60"	2,837	5,403	6,215
66"	2,983	5,555	6,366
72"	3,133	5,740	6,552

42" diameter	Single-Wall
6" height	\$1,561
14" height	1,917

48" diameter	
6" height	1,943
14" height	2,290

Channel for hold-down strap	792
-----------------------------	-----

Pump Vaults and Accessories

4' Pump Vaults

Wet Well Cylinder	Standard Resin	NSF Resin ¹
8'	\$ 8,519	\$9,445
9'	8,747	9,789
10'	10,252	11,410
11'	11,191	12,464
12'	11,741	13,130
13'	11,971	13,476
14'	12,520	14,140
15'	12,750	14,487
16'	13,300	15,152
17'	13,529	15,497
18'	14,388	16,472
19'	14,733	16,933
20'	16,351	18,667
21'	17,405	19,836
22'	18,069	20,616

FRP Vault Cover

Fiberglass cover with 12 galvanized bolts and gaskets **\$2,605**

Aluminum Vault Cover

54" O.D. aluminum cover with 24" x 40" hinged and lockable lid **\$4,428**

Note:

1. NSF label available from Anaheim, CA, or Hagerstown, MD, only.

Baffle/Partition Walls and Piping

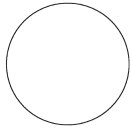

Full Baffle

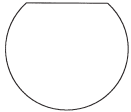

7/8 Baffle



Half Baffle

Internal FRP baffles are available in a range in sizes. (Call your Xerxes sales representative for 12'-diameter baffle pricing.) If baffle is to be installed in an NSF tank, the NSF price adder shown below must be added to the baffle price.

1. Select baffle diameter and height. If desired height is between sizes shown below, select the price for the larger baffle size.
2. Select the baffle price based on invert height for crossover piping and holes. (Full baffles require a crossover.)

10' Diameter Tank

Invert Height	Price
0-40"	\$ 3,647
41-60"	4,055
61-80"	5,602
81-120"	7,478
0-40"	3,420
41-60"	3,777
61-80"	5,330
81-104"	6,679
0-60"	3,628

10' Diameter NSF Adder +\$2,570

8' Diameter Tank

Invert Height	Price
0-60"	\$ 2,855
61-92"	3,192
0-60"	2,938
61-80"	3,821
0-46"	2,190

8' Diameter NSF Adder +\$1,588

6' Diameter Tank

Invert Height	Price
0-72"	\$ 2,040
0-36"	1,997
37-63"	2,444
0-36"	1,408

6' Diameter NSF Adder +\$1,045

4' Diameter Tank

Invert Height	Price
0-48"	\$ 1,381
0-42"	1,360
0-24"	1,045

4' Diameter NSF Adder +\$669

PVC Crossover Piping for Baffle/Partition Walls

Straight-Pipe Crossover

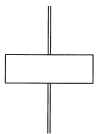

Diameter	Price
4"	\$399
6"	420
8"	445

Single-90 Degree Crossover

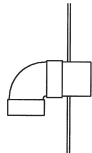

Diameter	Price
4"	\$451
6"	536
8"	713

Double-90 Degree Crossover

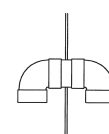

Diameter	Price
4"	\$511
6"	658
8"	979

Single-Tee Crossover

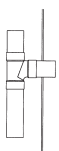

Diameter	Price
4"	\$ 549
6"	853
8"	1,046

Double-Tee Crossover

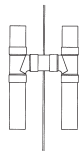

Diameter	Price
4"	\$ 913
6"	1,463
8"	1,813

Baffle Hole

Diameter	Price
Any diameter up to 10 inches	\$104

Tank Accessories

Large Bottom Sump

Price includes flanged opening in bottom of tank, bottom sump, and bolting hardware. (Field-assembly required except for 30" x 14".)

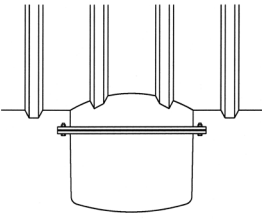

	Price
30" I.D. x 14" depth (factory-attached, no flange)	\$7,279
30" I.D. x 26" depth	8,203
30" I.D. x 36" depth	8,781
30" I.D. x 48" depth	9,475
48" I.D. x 48" depth	11,476

Factory Installation of Owner Supplied Effluent Filter

	Price
Filter siphon installation, single	\$1,163
Filter siphon installation, dual	2,327
Filter siphon installation, quad	4,652
Price ADDER per filter, when installed on a baffle/partition wall	535

Pump Platform

For use with pumps up to 300 lbs.

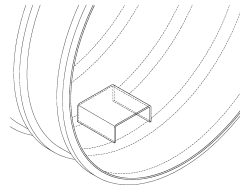

	Price
24" x 24"	\$1,144
24" x 36"	1,247
30" x 30"	1,295
36" x 36"	1,463

Sensor/Pipe Brackets

	Price
Per Bracket	\$227

Antivortex Plates

Several different design options are available. Consult your Xerxes sales representative for options.

	Price
Per Plate	\$1,463

Flanged Fiberglass Nozzles with Internal Fiberglass Vertical Pipe²

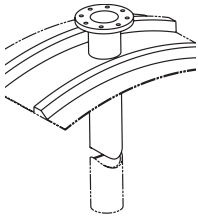

Flange Diameter	Tank Diameter				
	4'	6'	8'	10'	12'
2" diameter	\$1,475	\$1,523	\$1,571	\$1,618	\$1,662
4" diameter	2,006	2,100	2,190	2,283	2,374
6" diameter	2,484	2,645	2,813	2,974	3,134
8" diameter	3,035	3,305	3,571	3,836	4,105
10" diameter	4,041	4,435	4,828	5,222	5,618

Steel Full-Couplings with Internal PVC or FRP Vertical Pipe²

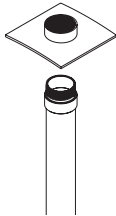

Fitting Diameter	Tank Diameter/Pipe Material									
	4' PVC	4' FRP	6' PVC	6' FRP	8' PVC	8' FRP	10' PVC	10' FRP	12' PVC	12' FRP
2" diameter	\$630	\$ 688	\$649	\$ 740	\$669	\$ 791	\$688	\$ 844	\$ 704	\$ 890
4" diameter	768	908	791	1,004	822	1,107	853	1,202	875	1,305
6" diameter	1,221	1,339	1,247	1,515	1,272	1,692	1,307	1,867	1,330	2,041

Ladders

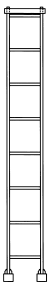

Material	Tank Diameter				
	4'	6'	8'	10'	12'
Aluminum or Fiberglass	\$1,478	\$1,733	\$2,058	\$2,528	\$2,999
Fiberglass, NSF-listed	1,711	2,014	2,389	2,930	3,479

Notes:

1. Customer supplies filter and/or siphon. Customer also must add one properly sized outlet straight pipe. See "Inlet/Outlet Straight Pipe, PVC or FRP" category.
2. Tank must have manway or access opening.

Tank Accessories

Striker Plates

Steel plate(s) encapsulated in fiberglass placed on the bottom of the tank under fitting, nozzle or manway.

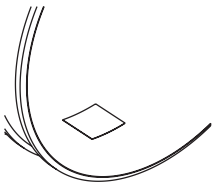

Striker Plates	Unit Price
Under 2" through 12" diameter fitting or nozzle	\$159
Under 22" or 30" diameter manway, 24"-diameter or 30"-diameter access opening	632
Under 36"-diameter manway	1,423

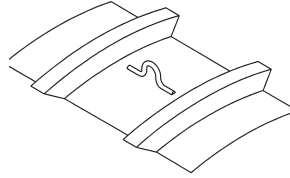

Tank Diameter	Unit Price
4, 6, & 8'	\$ 176
10'	419
12'	1,030

RST-II® Tank and Accessories

RST-II 1,000/1,500 Standard Assembled Tank

Standard Assembled Tank Includes:

- One 4" inlet sanitary tee with watertight grommet
- Outlet access opening cut to 20" I.D.

Nominal Gallons	Unit Price	ADDER for H-20 or Deep Burial*
1,000	\$3,556	\$1,687
1,500	4,350	2,116

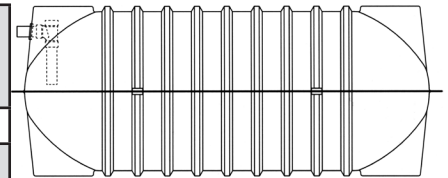

RST-II 1,000/1,500 IAPMO Listed Assembled Tank

IAPMO-Listed Tank Includes:

- One 4" inlet sanitary tee with watertight grommet at approximately 53" invert height.
- One 4" outlet sanitary tee with watertight grommet at approximately 51" invert height.
- One baffle/partition wall with one 90-degree elbow and one 4" vent hole.
- Inlet and outlet access openings cut to 22" diameter.

Nominal Gallons	Unit Price	ADDER for H-20 or Deep Burial*
1,000	\$4,385	\$1,687
1,500	5,194	2,116

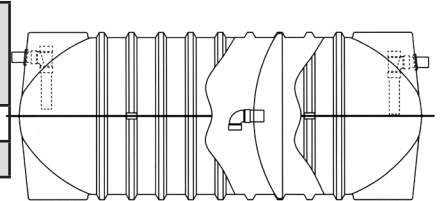

RST-II 1,000/1,500 Unassembled Tank Parts

Unassembled Tank Halves Include:

- Top and bottom pieces
- Field adhesive kit (cartridges of methacrylate adhesive)

Nominal Gallons	Unit Price	ADDER for H-20 or Deep Burial*
1,000	\$3,133	\$1,687
1,500	3,931	2,116

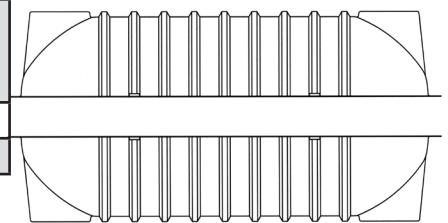

* H-20 or deep bury tanks up to 9ft.

Optional Accessories

Inlet/Outlet Sanitary Tee/Grommet

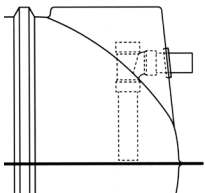

	Unit Price
Installed	\$298
Parts only	193

Baffle/Partition Wall

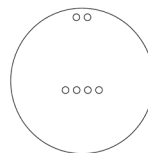

	Unit Price
Installed	\$402
Parts only	306

Methacrylate Adhesive



	Unit Price
Available in case qty. of 12 cartridges. (Requires use of a specific application gun.)	\$1,559

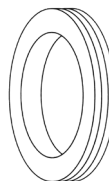

4" Watertight Rubber Grommet

	Unit Price
Kit includes six grommets	\$110

Terms and Conditions of Sale

- All orders are subject to Xerxes terms and conditions of sale.
- Prices are subject to change without notice.
- Cancelled orders are subject to a restock charge of up to 100 percent of the value of the order.
- Payment terms are subject to Xerxes review and approval.
- Payment terms may require a deposit at time of order.

General Notes

- Tanks 1,000 gallons and smaller requiring a skid for shipping will incur a net charge of \$500 per tank.
- Orders with a customer pick-up are subject to a net charge of \$200 per tank.
- For additional product information and installation instructions, refer to Xerxes product literature and Xerxes. Installation Manual and Operating Guidelines in effect at the time of installation.
- Limited warranties for specific products are available at www.xerxes.com .

Shipping Terms

- Freight will be invoiced based on Xerxes rate guide in effect at the time of shipment.
- Freight rates may also be subject to a fuel surcharge based on rates in effect at the time of shipment.
- Prices herein and freight rates invoiced are based on F.O.B. Xerxes or ZCL manufacturing facilities:

Xerxes Facilities

- Anaheim, CA
- Seguin, TX
- Tipton, IA
- Hagerstown, MD

ZCL Facilities

- Edmonton, AB
- Drummondville, QB



Xerxes Corporation
7901 Xerxes Avenue South
Minneapolis, MN 55431 USA
952-887-1890
www.xerxes.com